

Directions to Waterfront Park Offices

Address: 1600 Pacific Highway, San Diego, 92101

[Google Maps](#)

Nearest Highway Exits:

From 5-N, Hawthorn Exit → Left on Pacific Highway → Right on Ash, garage on right

From 5-S, Kettner Exit → Right on Sassafras → Left on Pacific Highway → Right on Ash, garage on right.

From 163-S → Ash Exit, take Ash all the way across Pacific Highway, then garage on right.

Parking Options:

- 1) Underground Parking is available off of Ash Street between Pacific Highway and Harbor Drive. Parking is free for three hours if you are here on County business. You may park in any of the white parking spots. There is an elevator available as well as two sets of stairs. If you take the elevator or stairs up, you will find yourself on the South end of the Waterfront Park. Follow the walkway leading to the County Administration Center where you will find our Waterfront Park Information Booth.
- 2) Metered spots are also available:
 - a. On Harbor Drive along the entire West edge of the park.
 - b. On Pacific Highway north of Cedar.

The Waterfront Park Information Booth is located just inside the South Entrance of the County Administration Center. Before you reach the metal detectors, just inside the main doors, our office is on your left. This entrance is at the end of a sidewalk leading from Ash Street. A park attendant will direct you from here to your meeting location.

Call 619-232-7275 if you are having trouble finding this location.

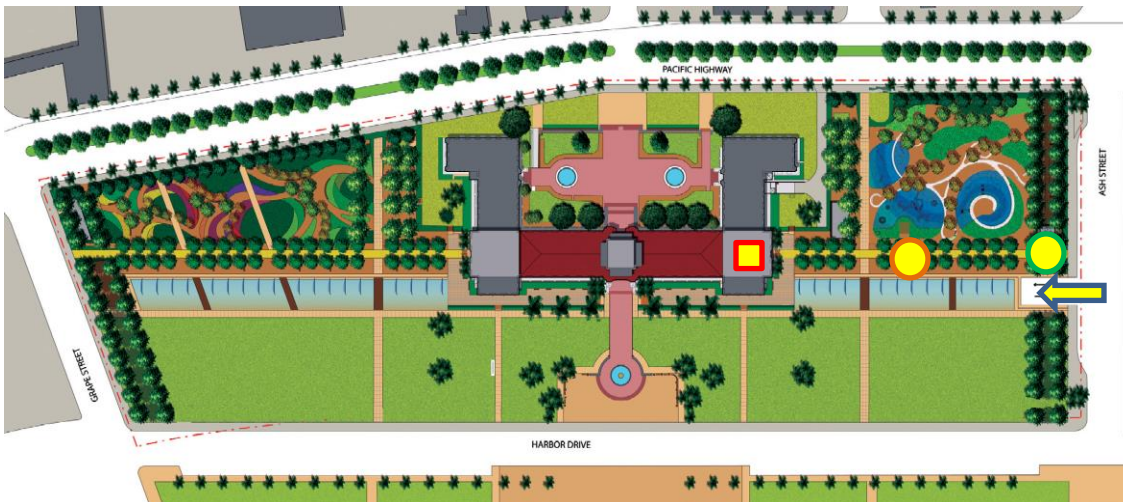

Waterfront Park Information Booth: ■

Garage Entrance from Ash Street: ←

Stairs from Garage to Park: ●

Elevator from Garage to Park: ●